



MiTTMail



INSTRUCTIONS

Quick Start

- » First of all, charge up MiTail. Simply connect the charger to MiTail with the supplied USB-C cable. The charger can charge it to around 80% in around 2h 15 minutes. (Using your own USB type A to C cable wont charge your tail.)
 - » Download the app from the app store. Search for “The Tail Company” or “Crumpet” or scan this QR code:
 - » Switch on MiTail by pressing the power button for 2 seconds. Its at the body end, under the fur.
- Please note, you can use MiTail whilst its charging, but not if the batteries are completely dead. So for the first time, please give MiTail a really good charge!
- » Run the app! Agree to the permissions it requires. It will then look for your tail. After a short while, it should find it. Click “Connect to MiTail”, and you are ready to go!
 - » There is no need to “pair” your tail! Just use the app to search and connect.
 - » When MiTail is running low on batteries, the app’s battery gauge will go red. The red LED on MiTail will also blink to let you know. Time to charge!



To switch off MiTail, press the power button for about 4 seconds and MiTail will power off. If MiTail is unused for 5 minutes, it will switch itself off to save power.

You can also use MiTail with a powerbank when your batteries are low. Just connect it up, and MiTail will charge while it moves. But be careful not to break the USB socket.

FAQ

- If your phone can’t see MiTail, make sure the tail is on, and has been charged! Also make sure Bluetooth is ON and **location permissions are enabled in Settings**. You don’t need to “Pair” it. Just run the app and follow the instructions there.
- You must agree to the app permissions when you install the app, or it wont be able to find your MiTail. Sometimes, rebooting your phone can fix issues.
- If you have trouble with anything MiTail, please visit our [Telegram group](#) or email us! We also discuss new features and new gear we are working on there too.
- Its not usually a good idea to brush your tail covers too much. If they have marks, use a damp cloth to rub them. Or use your fingers to remove anything that may be stuck there. They are not suitable for dry cleaning. A little light brushing is fine.

How to use the D-Clip

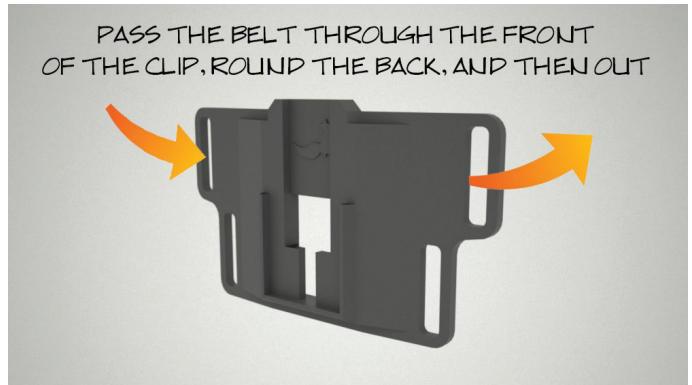
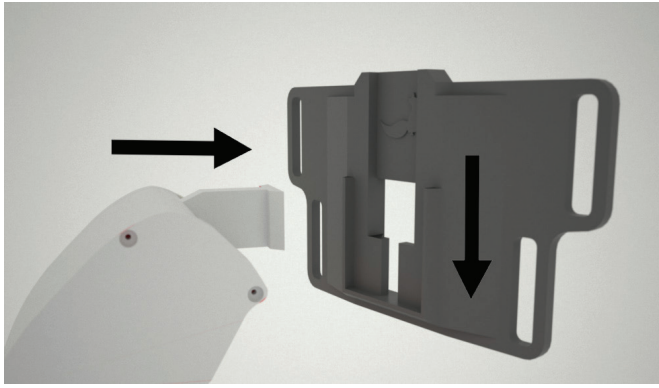

- Don't sit down with your tail on! With the new D-Clip, its easy to remove the tail, and reattach. If you leave it on, and it tries to move, it can damage the insides.
- There is an extra guide with some dos and donts linked here and in the app. Please read it so your tail keeps wagging happily.

Technical stuff about MiTail

MiTail requires a USB-PD capable charging adapter. PD charging is only possible via a type-C USB connector. Adapters with USB-A output will not charge MiTail, nor will a C to A lead. The adapter should provide at least 9V - almost all PD adapters can. If the adapters' rated power is less than 24W, charging will take around 3 hours. The current firmware (4.11) sets the max charging speed. Powerbanks behave the same as above.

This is what the LEDs mean:

Red LED - **OFF** when not charging or not connected to a suitable charger. "**Breathing fades**" when charging, increasing in speed as charging increases. And **SOLID ON** when charged!

Blue LED - **Blinking** means its ready to connect. **ON** means MiTail is connected to your phone.

IMPORTANT! TREAT YOUR USB WITH CARE!

You can break your USB socket if you dont treat it well! Please be gentle when connecting and disconnecting the USB lead

TAKE EXTRA SPECIAL CARE WHEN CONNECTING A POWERBANK AND THEN USING YOUR TAIL

If you apply pressure to one side of the connector, you can break your tail!

Always use a 90 degree USB-C lead when using a powerbank.

Disclaimer

Please read the instructions for use above in full before using your Tail Company Gear. Not familiarising yourself with the proper method of use could cause damage to the gear, or to yourself, or both. This text is also subject to change. An up-to-date version will form part of the file available at <https://thetailcompany.com/eargear.pdf> or <https://thetailcompany.com/mitail.pdf> Support is also available on our website, through the chat service, or on our Telegram group.

By using this item, you hereby acknowledge that you have read this disclaimer and that you understand and agree to abide by the terms and conditions herein.

The Mechanical Tail Company Ltd accept no liability for damage, injury or legal responsibility incurred directly or indirectly from the use of this product. This product is not a toy, and should not be used by children under the age of thirteen years without supervision by an adult. Do not use the product if it appears damaged in any way.

Safety

Handle your EarGear or MiTail with care. They can be damaged, functionally impaired or broken if dropped, burned, punctured, crushed, disassembled or if exposed to liquid, excessive heat or other environmental conditions. EarGear and MiTail should be kept out of the reach of children and pets under 13 years of age when unsupervised.

Only use the supplied charging equipment for your Tail Company gear. Use of incorrect charging apparatus that does not meet international standards can cause fire, electric shock, injury or damage to you or the gear or other property. Whilst powerbanks and other chargers can be connected to our gear, we can accept no responsibility for their use or for any damage they may cause, either electrical or to the connections on your gear, such as the USB socket.

Do not charge EarGear or MiTail unattended. If at any time the items give off an odour, exude smoke, or show other signs of damage, stop using the items immediately, and dispose of them in the correct manner.

Environmental Requirements

Operating temperature: -10 to 40 C / 14 to 104 F

Charging temperature: 10 to 30 C / 50 to 86 F

Storage temperature: 0 to 30 C / 32 to 86 F

For certification information, as well as trademarks and design registrations, please visit <https://thetailcompany.com/ip-and-legal/>